

HUNTONIT

PREPAINTED WALLS AND CEILINGS

524 04,21

NEW COLORS AND SURFACES

FOR YOUR INSPIRATION



THE NORWEGIAN
ASTHMA AND ALLERGY
ASSOCIATION
- making people healthier

member of

BYGGMA
group



PRODUCT FACT

- Huntonit pre-painted wall and ceiling panels are produced in Norway with nothing but pure natural wood fibers. The fibers are compressed and fused together in a heat and wather proses with no additive substance
- The panels are treated with five coats of environmentally friendly watherbased acrylic paint. Finishing layer is a protective coating
- The panel has fire- (D-s2,d0) and sound-absorbing effect (sound diminishing cladding). Technically approved by SINTEF and may be used in REI30- and REI60- structures
- The panels are dense, making it possible to install screw fixed bookshelves and lamps directly on to the panels
- Recommended by the Norwegian Asthma and Allergy Association (NAAF)
- Holds the Indoor Climate Label

Huntonit Panelborad White - brush painted used in bathroom

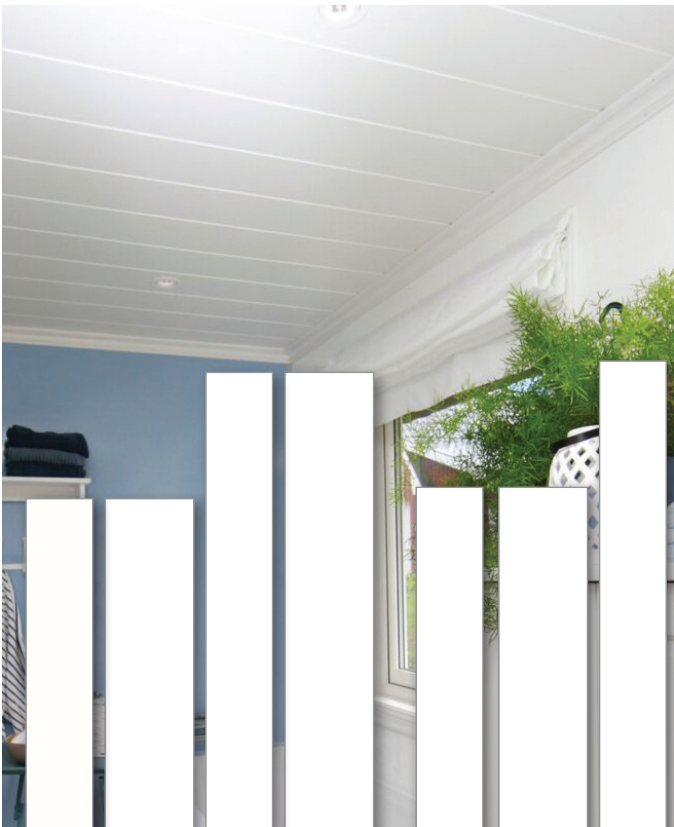

BRUSH PAINTED

SINGLE PANEL BOARD

Single panel board with brush painted surface and wood structure. May be used horysontally or vertically onto ceiling or the wall. Short side extension with V-fas provide a clean appearance where panels need to be spliced, maximum coverage beyond 2400mm.

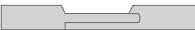

LONG SIDE EXTENSION
IN SKYGGE PROFILE



SHORT SIDE EXTENSION
IN SKYGGE PROFILE

Huntonit Panel board White - brush painted	(net size:11x180x2400)	11 x 200 x 2420 mm
Huntonit Panel board White - brush painted	(net size:11x125x2400)	11 x 142 x 2420 mm
Huntonit Panel Board White - brush painted	(net size 11x180x3000)	11 x 200 x 3020 mm
Huntonit Panel Board White - brush painted	(net size 11 x125x3000)	11 x 142 x 3020 mm

Huntonit Panel board Brilliant - brush painted	(net size:11x180x2400)	11 x 200 x 2420 mm
Huntonit Panel board Brilliant - brush painted	(net size:11x125x2400)	11 x 142 x 2420 mm
Huntonit Panel Board Brilliant - brush painted	(net size 11x180x3000)	11 x 200 x 3020 mm
Huntonit Panel Board Brilliant - brush painted	(net size 11 x125x3000)	11 x 142 x 3020 mm



White White White White White Brilliant White Brilliant White Brilliant White Brilliant

PAINTED CEILING PANEL

LONG AND SHORT SIDE
EXTENSION IN V-FAS PROFILE



Brilliant White, brush painted	11 x 300 x 1220 mm
Brilliant White, brush painted	11 x 620 x 1220 mm
Classique painted	11 x 300 x 1220 mm
Classique painted	11 x 300 x 1820 mm
Classique painted	11 x 620 x 1220 mm
Symfoni painted	11 x 300 x 1220 mm
Symfoni painted	11 x 300 x 1820 mm
Plankett painted	11 x 300 x 1220 mm
Plankett painted	11 x 300 x 1820 mm

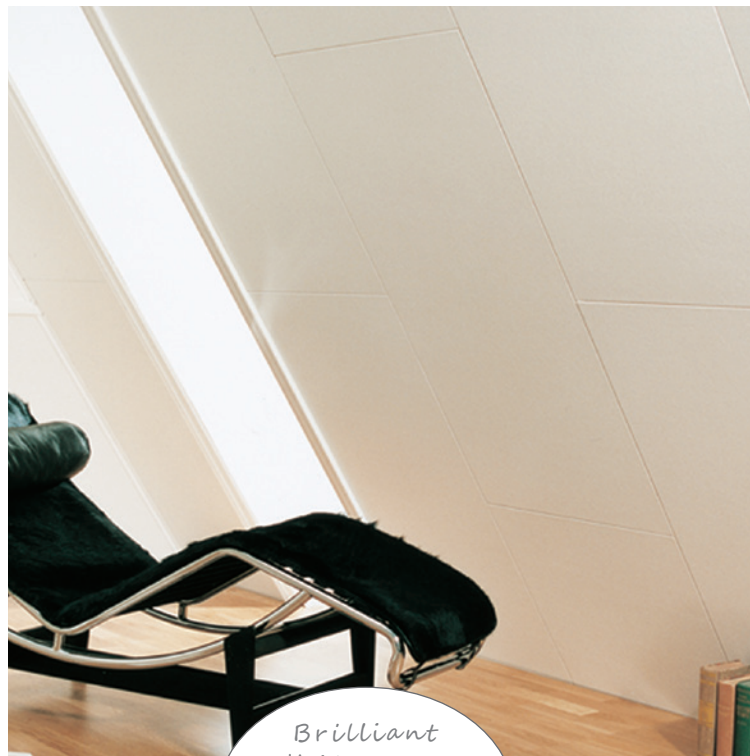

*Brilliant
White comes
with a smooth
brush painted
surface*

Symfoni ceiling and Perle wall

Classique ceiling



Brilliant ceiling



NCS CODES:

Brilliant White
NCS S 0500-N

White
NCS S 0502-Y

RUSTIKK SINGLE PANEL BOARD

Huntonit single panel board Rustikk has a wood structured surface. Available in 6 colours.

The panles possesses a natural variation in color and structure that gives the wall and / or ceiling a lifelike expression.

Røst	(net size:11x125x2400)	11 x 142 x 2420 mm
Lindesnes	(net size:11x125x2400)	11 x 142 x 2420 mm
Færder	(net size:11x125x2400)	11 x 142 x 2420 mm
Lillesand	(net size:11x125x2400)	11 x 142 x 2420 mm
Saltdal	(net size:11x125x2400)	11 x 142 x 2420 mm
Svalbard	(net size:11x125x2400)	11 x 142 x 2420 mm

Rustikk Lindesnes



Rustikk Svalbard



Rustikk Røst

LONG SIDE EXTENSION
IN RUSTIKK PROFILE



SHORT SIDE EXTENSION
IN RUSTIKK PROFILE



Røst



Lindesnes



Færder



Lillesand



Saltdal

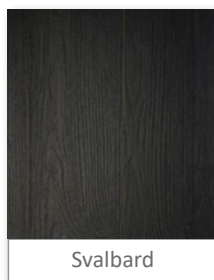

Svalbard

*colors
available
in Rustikk*

OBS: pictures may differ from real life product. Please see sample at your dealer.
The design illustrations show 4 tables assembled - corresponding a panel size of 50x56 cm.



BRUSH PAINTED SKYGGE WALL PANEL

Huntonit brush painted wallpanel in Skygge profile is suitable for anyone who wants an classical and timeless look.

Beautiful brush painted surface, light colors and the natural wood fiber core makes Skygge panel a choice for the future. Now also with a wide range of new colors.

Available in 2 pack for your convenience.

The panel have five boards, each 120 mm wide. Tongue and groove allows quick and easy installation with concealed nailing. Mount on existing wall or directly on to stud.

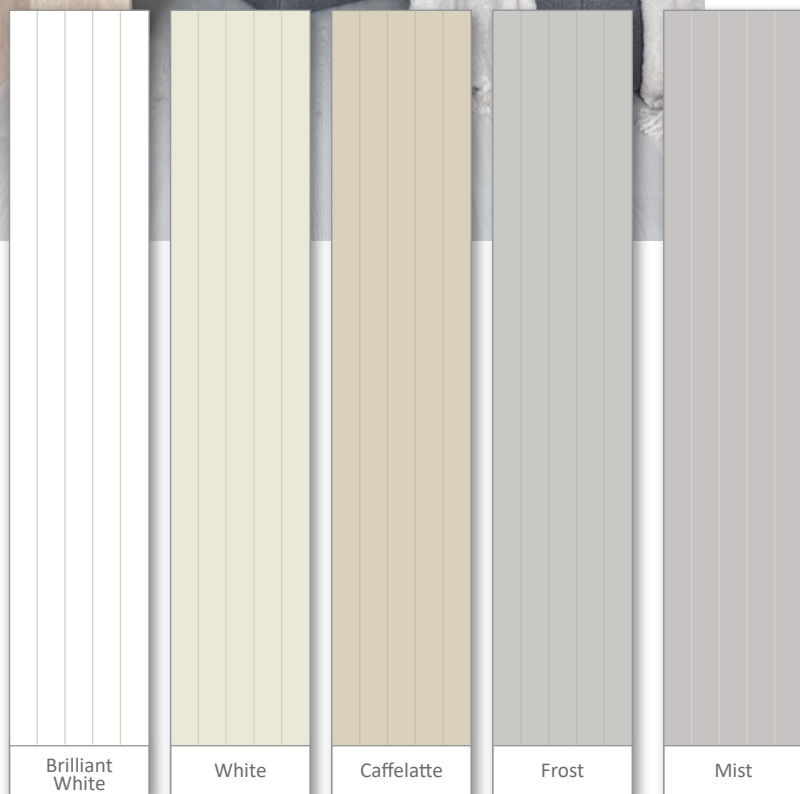

Skygge Brilliant White	11 x 600/620 x 2390 mm
Skygge White	11 x 600/620 x 2390 mm
Skygge White	11 x 600/620 x 2740 mm
Skygge White	11 x 600/620 x 3050 mm
Skygge Caffelatte	11 x 600/620 x 2390 mm
Skygge Frost	11 x 600/620 x 2390 mm
Skygge Mist	11 x 600/620 x 2390 mm
Skygge Sand	11 x 600/620 x 2390 mm
Skygge Earth	11 x 600/620 x 2390 mm
Skygge Soft Menthol	11 x 600/620 x 2390 mm
Skygge Soft Eucalyptus	11 x 600/620 x 2390 mm
Skygge Deep Ocean	11 x 600/620 x 2390 mm
Skygge Pepper	11 x 600/620 x 2390 mm
Skygge Terracotta	11 x 600/620 x 2390 mm
Skygge Evening sky	11 x 600/620 x 2390 mm
Skygge Matt black	11 x 600/620 x 2390 mm

SKYGGE PROFILE





Skygge Earth

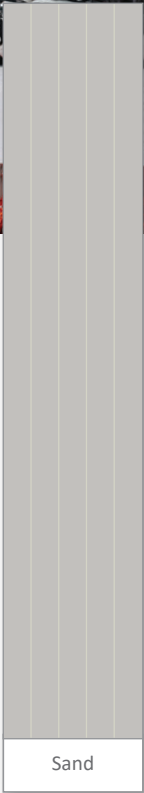

Sand

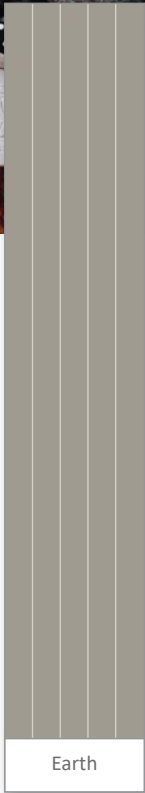

Earth

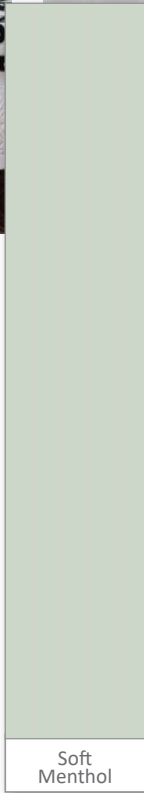

Soft
Menthol

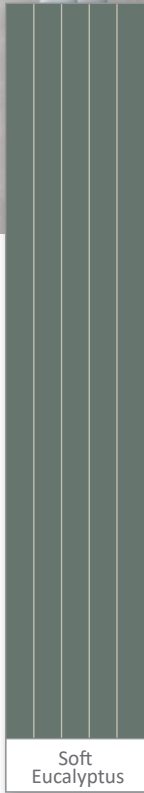

Soft
Eucalyptus

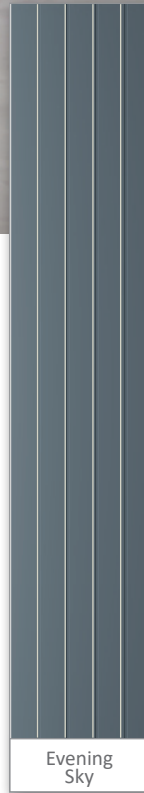

Evening
Sky



Deep
Ocean

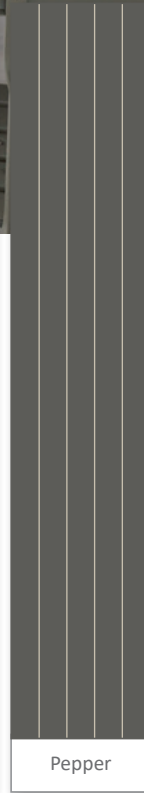

Pepper

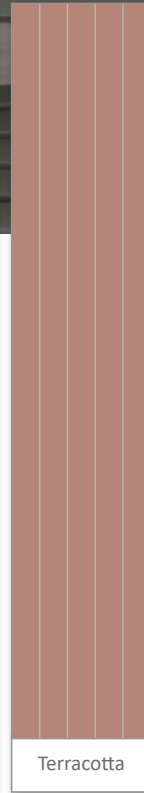

Terracotta

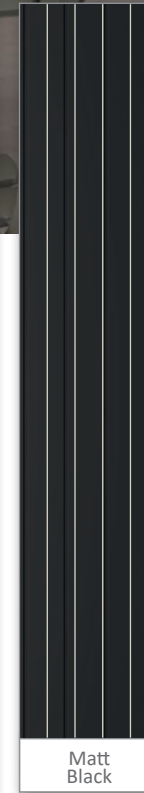

Matt
Black

Huntonit Perle White



Huntonit Perle Brilliant white



Colors
available
in Perle



BRUSH PAINTED PERLE WALL PANEL

Huntonit pre painted panels with Perle profile; a classick and elegant appearance for your walls.

Brush painted surface, light and timeless colors, 2 pack and the natural and pure core material provides you will be satisfied with for years to come.

The panel consist of 5 boards; each 120 mm wide. The panel has tongue and groove and is very easy and quick to install with concealed nailing, either on an existing wall or directly on to stud. Huntonit wallpanel with smooth prepainted surface is durable and easy to clean.

PERLE PROFILE



Perle Brilliant White	11 x 600/620 x 2390 mm
Perle Brilliant White	11 x 600/620 x 2740 mm
Perle White	11 x 600/620 x 2390 mm
Perle White*	11 x 600/620 x 2740 mm
Perle Caffelatte	11 x 600/620 x 2390 mm
Perle Frost	11 x 600/620 x 2390 mm

BRUSH PAINTED ANTIKK WALL WITH MICROJOINT

Huntonit Antikk with microjoint; a wall panel with discrete joint and without milled boards. The Microjoint gives the panels a minimal joint. the surface is strong and brush painted.

LONG SIDE EXTENSION IN MIKROFUGE



White	11 x 600/620 x 2390 mm
White	11 x 600/620 x 2740 mm
White *	11 x 600/620 x 3050 mm
Brilliant White	11 x 600/620 x 2390 mm
Brilliant White*	11 x 600/620 x 2740 mm
Frost	11 x 600/620 x 2390 mm
Frost*	11 x 600/620 x 2740 mm
Mist	11 x 600/620 x 2390 mm
Mist *	11 x 600/620 x 2740 mm

*must be ordered



Brilliant White

White

Frost

Mist

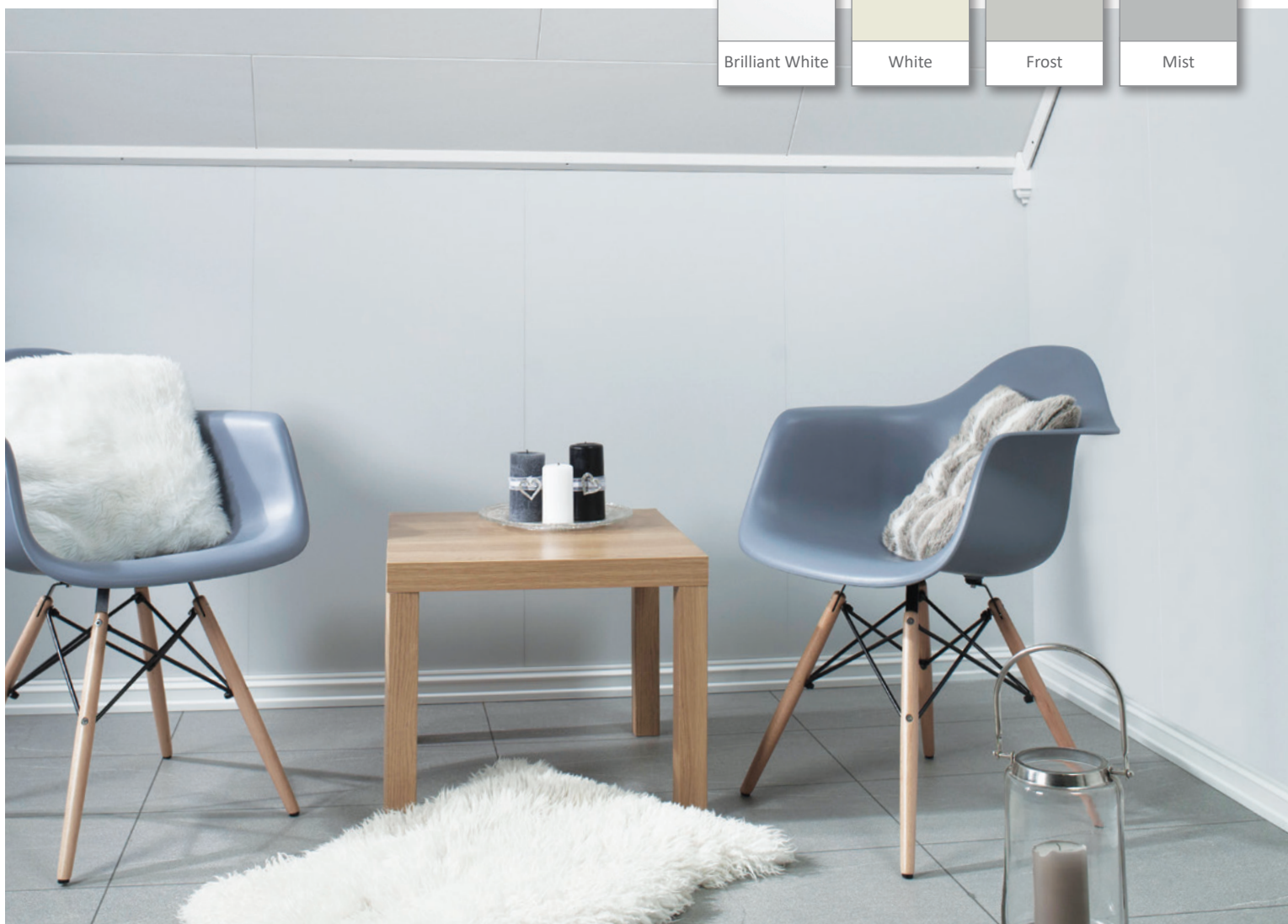



BRUSH PAINTED TEXTURE WALL

Wallpanel with 5 boards faspanel with brush painted and wood textured surface that appears through the glazed color.
For walls with a vibrant look.

Huntonit glazed Symfoni Frappe
Huntonit Wood white

11 x 600/620 x 2390 mm
11 x 600/620 x 2390 mm



Faspanel 8 bord White



PRE PAINTED

FASANEL 3 BORD

Huntonit brush painted Faspanel 8 bord consist of thre boards. The panel has tongue and groove and is very easy and quick to install with concealed nailing, either on an existing wall or directly on to stud.

Delivered in 2 pack.

V-FAS PROFILE



Hvit	11 x 600/620 x 2390 mm
Hvit*	11 x 600/620 x 2740 mm

*must be ordered

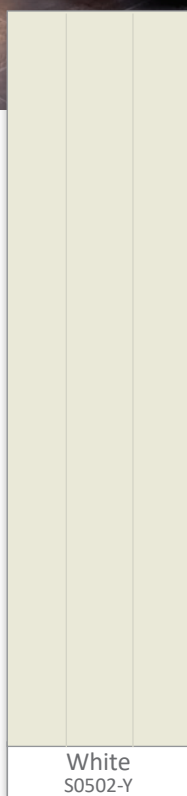

White
S0502-Y

Faspanel 8 bord White

PRE PAINTED

FASPANEL 8 BORD

Huntonit brush painted Faspanel 8 bord consist of eight boards, each 75mm wide. The panel has tongue and groove and is very easy and quick to install with concealed nailing, either on an existing wall or directly on to stud.

Delivered in 2 pack.

V-FAS PROFILE



Hvit	11 x 600/620 x 2390 mm
Hvit*	11 x 600/620 x 2740 mm
Frost	11 x 600/620 x 2390 mm
Frost*	11 x 600/620 x 2740 mm

*must be ordered

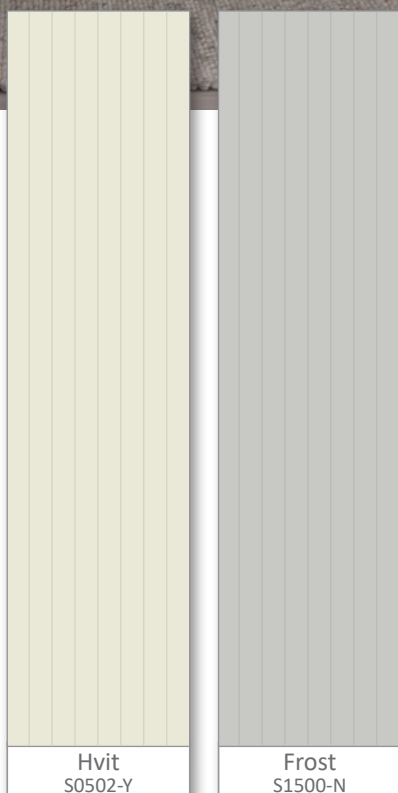

PRE PAINTED

FASPANEL 6 BORD

Huntonit pre painted wall panel in Faspanel 6 bord with brush painted surface has a nostalgic and elegant look.

Available in 2 pack for your convenience.

The panel consist of 6 bord, each 100 mm wide. The panel has tongue and groove and is very easy and quick to install with concealed nailing, either on an existing wall or directly on to stud.

The smooth surface on the Faspanel 6 bord do not collect to much dust and is easy to clean. The panel has the advantage that they can easily be painted.

Faspanel 6 bord Matt Black



V-FAS PROFILE



Hvit	11 x 600/620 x 2390 mm
Hvit*	11 x 600/620 x 2740 mm
Mist	11 x 600/620 x 2390 mm
Mist *	11 x 600/620 x 2740 mm
Alladin	11 x 600/620 x 2390 mm
Pilasterblue	11 x 600/620 x 2390 mm
Eveningsky	11 x 600/620 x 2390 mm
Matt Black	11 x 600/620 x 2390 mm

*must be ordered

Faspanel 6 bord Eveningblue



New colors
available
in Fas 6

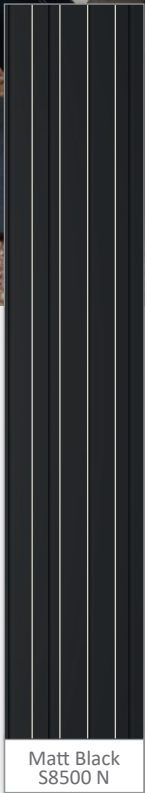
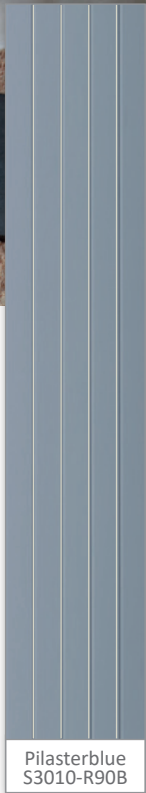
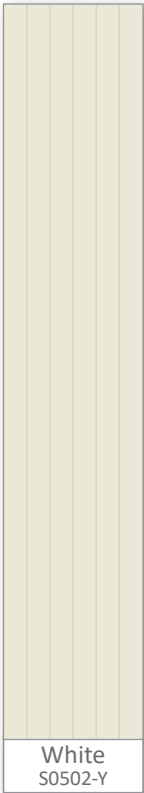



PAINTED BRANNIT



Fire-resistant ceiling and wall panel.

Tested by SINTEF - Norway's Fire Research laboratory testify that Huntonit Brannit meets the requirements for level K10 - B-s1,d0 - according NS-EN 13986-2004.

Huntonit Brannit prepainted panels provides shorter construction times and improved overall economy. Huntonit Brannit wall- and ceiling panel are easy to work with and has a tongue and groove on two sides. Ceilings are delivered with tongue and groove on all four sides. The panels are treated with flame retardants paint.

Delivered in 4 pack.

Brannit Ceiling White	11 x 600/620 x 1200/1220 mm
Brannit Wall White	11 x 600/620 x 2390 mm
Brannit Wall White*	11 x 600/620 x 2740 mm

*must be ordered

MAINTENANCE

To maintain fire classification B-s1,d0, repaint Huntonit Brannit panel with Palett. Palett Paint may be obtained in all NCS codes and gives great freedom of choice when it comes to renovation and maintenance of the installed Huntonit

Brannit panel. Palett maintenance system is tested by SINTEF. Contact us for further information.



PRE PAINTED PANEL BOARD INSTALLATION

Before installation: check the panel for any damage or difference in color.

Huntonit is a natural product made of wood fiber pulp; variation in color and appearance may occur. It is recommended to use panel from the same production or batch number.

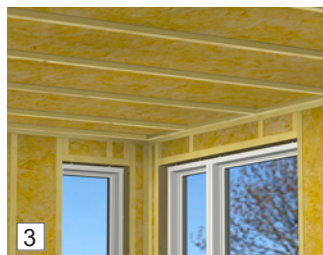
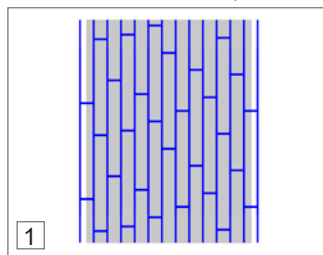

3. Mount across electric beams/beams with a max distance c/c 60 cm. When mounting on existing roof; test if the material has the strength to fix the screws. If not; locate the beams and fix the screws to them.
4. Cut to the first panel according to the correct width. When cutting with circular saw, the painted side should face down.

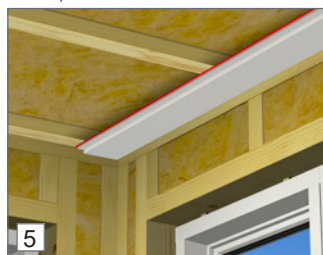

5. Mounted the first row after string / chalk cord for a straight start.
NB: mount with approximately 10 mm distance to all walls.
6. Distance to wall and between nails; c/c 150 mm. Double nailing/screw on each beam.



7. To avoid damage to the panel, use a nail setter when using nails.
8. The panel is to be spliced at the nail; c/c 150 mm. Double nailing/screw on each beam.

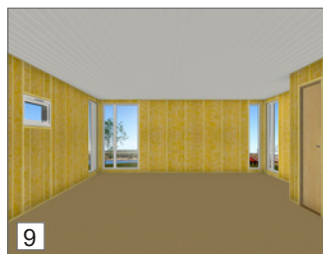

9. Mount the rest of the panel.
Tadaa - your new ceiling is done!

You may mount recessed down lights in all our ceiling panels. You can also install our panels in wet rooms, provided normal ceiling height and good ventilation is available.

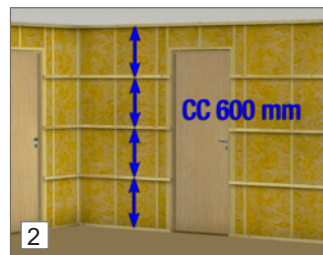
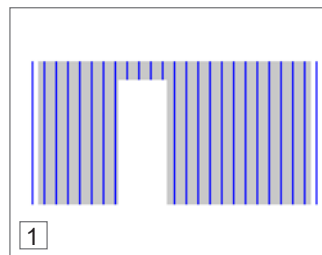

1. Distribute the panel so that first and last panel become equally wide.
2. If the panel are to be mounted upright, the wall must be leaked out with horizontal battens at c/c 60 cm.



- 3/4. Fit blocks in inside and outside corners.

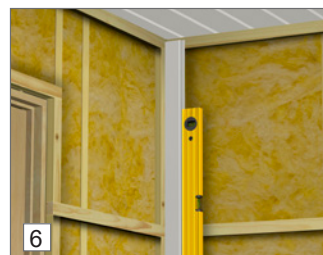

5. The first panel is cut and mounted at a distance of 10 mm from the floor and ceiling.
6. Use a leveler so the installation gets a right start.

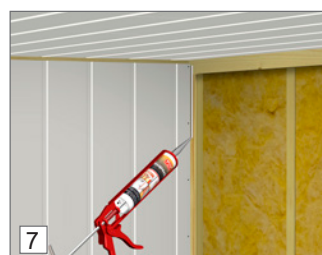

7. First panel on a new wall should be glued with Casco superfix or PL 400.
8. Double nailing/screw on each leak/beam.



9. Use correction paint delivered in 20 ml to cover marks made by screws and nails.
10. For external and internal corners; use Huntonit's corner profile.

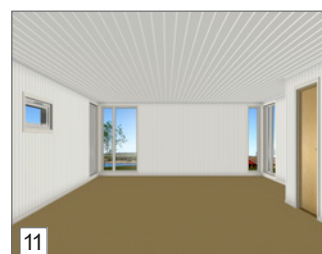

11. Tadaa - your walls are done!

PRE PAINTED PANEL BOARD INSTALLATION

HORIZONTAL WALL MOUNT

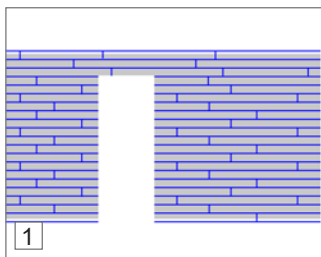

1. Distribute the panel so that top and bottom panel become equally wide.

2. Acclimatize the panel, in the packaging, for two days at room temperature before installation.



3. Mount across studs with a distance of max 60 cm. When mounting on existing wall; test if the material has the strength to fix the screws. If not; locate the beams and fix the screws to them.

4. Cut to the first panel according to the correct width. When cutting with circular saw, the painted side should face down.



5. Mount the profiles of your choice.

6. Tadaa - your walls are done!

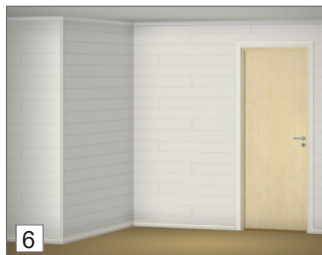













Byggma ASA is working hard on quality control. Despite this quality assurance, some errors may occur. The user must check the panel before mounting - in which our liability is limited to replacement of faulty panels. The manufacturer reserves the right to alter specifications when changes and printing errors occur.

WALL AND CEILING

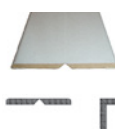
ACCESSORIES

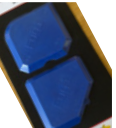
Huntonit pre-painted wall- and ceiling are supplied with tongue and groove for quick installation and hidden nailing gives a assured result. Mount on existing wall or directly onto stud Huntonit pre-painted wall- and roofpanel are the only pre-painted product recommended by the Norwegian Asthma

and Allergy Association. Huntonit panels are also approved with Indoor Climate Award from the Danish Technological Institute. Huntonit product is equip with M1; Emission classification of building materials, by the Building Information Foundation RTS.

 <p>CORNER CLIPS Use this corner clip when mounting our panel and avoid visible staples in the corners. NB! Only on wooden studs, use 3 pieces per panel.</p>	 <p>ACRYL FILLER For sealing internal corners. 1 tube is enough for approx. 20 lm joint 3 x 3 mm. Available in different colors.</p>	 <p>CORRECTION PAINT Correction paint delivered in 20 ml to cover marks made by screws and nails. Available in different colors.</p>	 <p>MOLDING PAINT 1/2 liter paint delivered in different colors to match the color of our panels.</p>
 <p>SPECIAL PROFILE List for use on windows and doors where a second board layer are mouted (renovation). Available in primed white.</p>	 <p>EXT CORNER PROFILE For use in external corners. Length: 2700 x 28 x 28 mm. Available in different colors.</p>	 <p>INT CORNER PROFILE For internal corners. Length: 2700 x 12 x 12 mm. Available in different colors.</p>	 <p>FEXIBLE CORNER External and internal use. (White) Dim. 28x28x3000mm</p>
 <p>SCREWS Adapted to 11 mm pre-painted panel. Wall: 4,2 x 35 mm. Ceiling: 4,2 x 25 mm.</p>	 <p>JOINT KIT When grouting corners we offer a joint set that is perfect for this purpose.</p>	<div data-bbox="903 1664 1150 1738">  <p>THE NORWEGIAN ASTHMA AND ALLERGY ASSOCIATION <i>- making people healthier</i></p> </div> <div data-bbox="1158 1664 1230 1738">  </div> <div data-bbox="1238 1664 1310 1738">  </div> <div data-bbox="1318 1664 1390 1738">  </div>	

OTHER INSTALLATION TIPS



In the inside corner the last panel may be attach to the stud with construction adhesive. If so you do not need clips or nailing. If last panel is installed against an outer wall with plastic wrap, one can not use adhesive. The panels may also be glued to brick/concrete. (see our installation instructions).

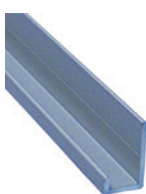

In buildings where there high demands on cleaning, eg. public buildings, institutions, etc., a base profile may be used to protect the edge of the panel. This solution is used when the panels need to be lifted off the floor (ex. 50mm.).

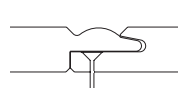

Huntonit pre-painted wall- and ceiling panel are equipped with tongue and groove for quick and easy installation with concealed nailing. The joints shall be glued. Nail distance: 150 mm.

PRE PAINTED WALL PANEL INSTALLATION

Before installation: check the panel for any damage or difference in color.

Huntonit is a natural product made of wood fiber pulp; variation in color and appearance may occur. It is recommended to use panel from the same production or batch number.



1) Acclimatize the panel at room temperature, for 2 days, and install immediately after the package is opened. Mount across electric beams/beams with a max distance c/c 60 cm. May also be mounted on horizontal beams (c/c 60 cm). Each mount should then be fixed with double nailing/screw on each beam.

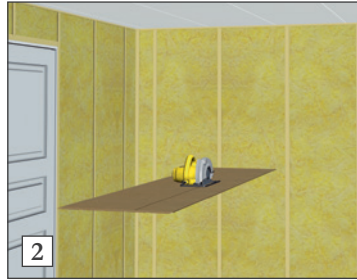

2) Cut to the first panel according to the correct width. When cutting with circular saw, the painted side should face down.



3) Use a leveler so the installation gets a right start.



4) Mount the panel 10 mm from the floor / ceiling. Tip: Place 2 blocks under the wall plate to facilitate the installation.

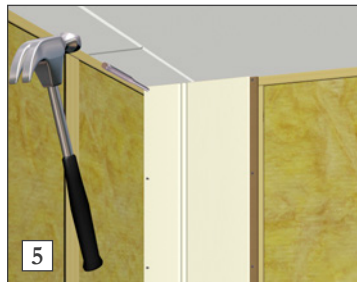

5) Distance between nails; c/c 150 mm. To avoid damage to the panel, use nail setter when using nails. In the first corner, the nails will be hidden by the last panel mounted. Cramps and screws may also be used.

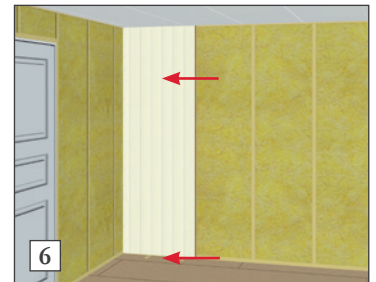

6) Do not glue the joints. Next plate is put in place. The wall plates are supplied with groove, spring and v-joint for concealed nailing.

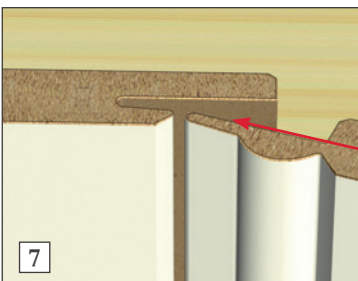

7) The spring side of the plate is inserted into the groove.



8) This provides a concealed joint that does not need to be glued.

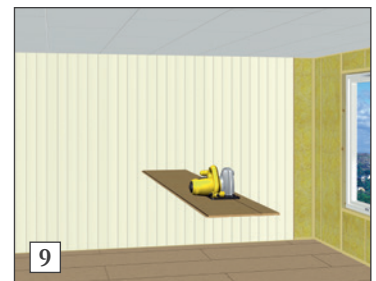

9) The last panel towards the next corner is cut. When cutting with circular saw, the painted side should face down.

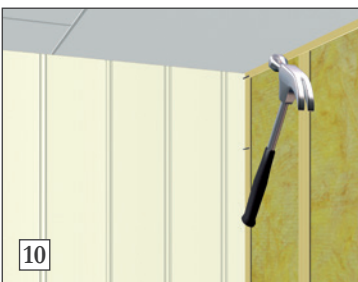

10) Last panel towards the corner is nailed along the cornerside. These nails are hidden by the 1st plate on the next wall. Cramps and screws can also be used (see also mont. M004-01-04).

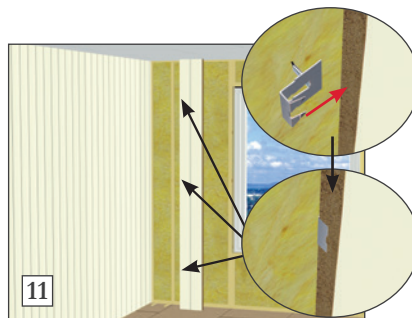

11) Cut the first plate, according to the correct width, for next wall. Corner clips are used for concealed nailing at the inside corner. Affix the corner clip completely into the plate. Use 3 corner clip alongside the panel and a nail at the top and bottom of the panel. These nails will be hidden by cornice and skirting.



12) The next first panel is placed tightly in the corner and tapped in place at each corner clip.

PRE PAINTED WALL PANEL INSTALLATION

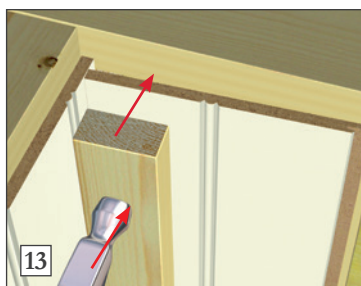

13) Protect the panel with a shim when you knock it in place.

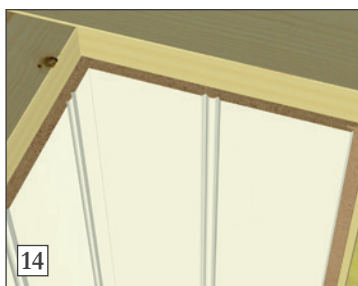

14) Make sure the panel is completely knocked in.



15) The panel is nailed in the nail lip. In the corner, the panel is nailed visibly with dive pins (by hand). Secure top and bottom as usual. Use correction paint (in correct colour) to cover the visible nails.



16) The rest of the panels are mounted in the same way.

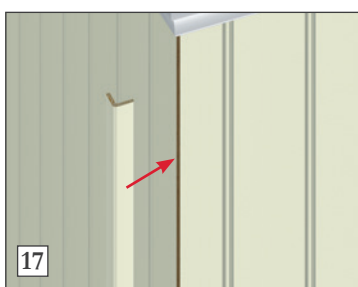

17) At external corners use the Huntonit corner profile

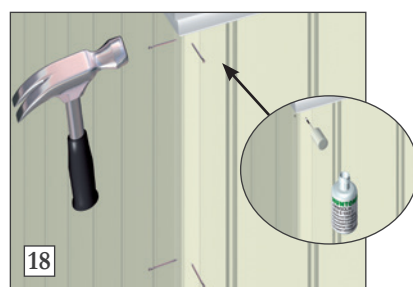

18) Staple the corner profile (c/c 300mm) and cover the staples with the correction paint. Correction paint is delivered in 20 ml to cover marks made by screws and nails. Available in different colors. To be used sparsely due to visual difference in surface structure.

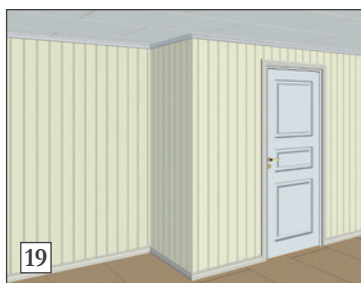

19) This provides a perfect external corner. The external corner profile may also be glued on.

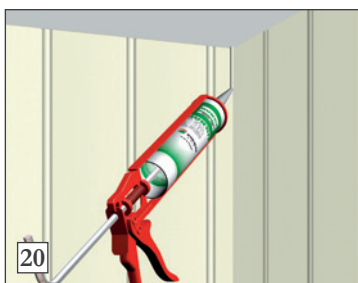

20) Huntonit also deliver Akryl Filler in original colours. To be used in internal corners.

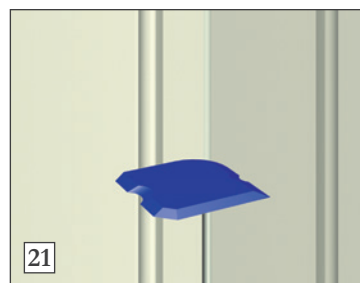

21) When akryl filler is used we reccoment a joint kit that is perfect for this purpose.



22) Huntonit can provide a special profile. This is for use on windows and doors where a second board layer are mouted (renovation). Available in primed white.



23) Molding paint, 1/2 liter, is delivered in different colors to match the color of our panels.



24) Huntonit panel is avable in several types and colors, and with accessories that make the job easy and give a professional result.

PRE PAINTED CEILING PANEL INSTALLATION

Before installation: check the panel for any damage or difference in color.

Huntonit is a natural product made of wood fiber pulp; variation in color and appearance may occur. It is recommended to use panel from the same production or batch number.

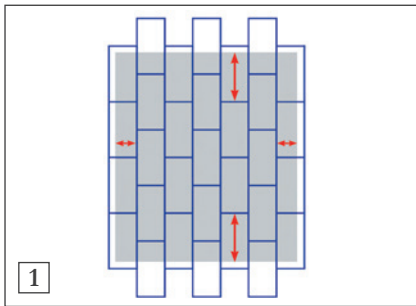

1) Acclimatize the panel at room temperature, for 2 days, and install immediately after the package is opened. A drawing is made prior to installation for calculating the consumption of roof panel.

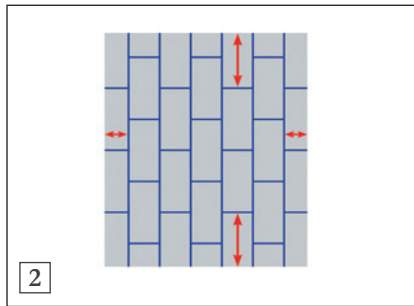

2) The principle of the drawing is to show the best solution of the pattern in the ceiling and how the panel must be adapted before mounting. Keep the distance to walls and fixed points at 7-10 mm.



3) Mount across electric beams/beams with a max distance c/c 60 cm. All panel edges without adjacent panel must be supported. When installing narrower ceiling panels, the beam distance must be adjusted to fit the width of the panel.



4) Cut to the first panel according to the drawing. When cutting with circular saw, the painted side should face down.



5) Mount the first row after string / chalk cord for a straight start. Distance to wall and between nails; c/c 150 mm. NB: mount with approximately 10 mm distance to all walls.



6) To avoid damage to the panel, use nail setter when using nails. Cramps and screws may also be used.



7) The panel is to be spliced at the beam and should not be glued. Distance between nails; c/c 150 mm. Avoid damage to the panel, use a nail setter when using nails. Cramps and screws may also be used. (see mont. M005-08-04).

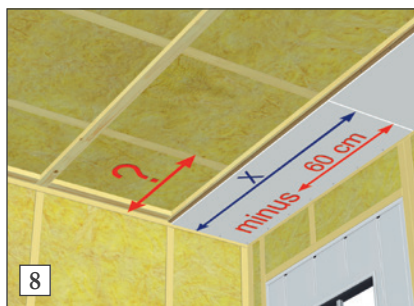

8) To find the length of the 1st panel in the second row, subtract 60 cm from the length of the 1st panel in the 1st row.

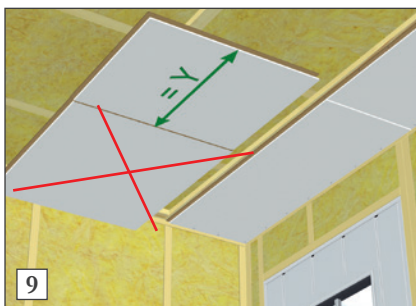
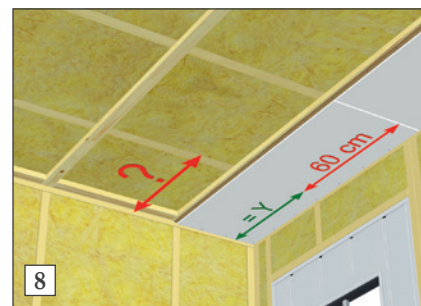

9) Measure and mark the 1st panel in the 2nd row. The excess part is cut off. When cutting with circular saw, the painted side should face down.



10) Mount the rest of the panel. Tadaa - your new ceiling is done!

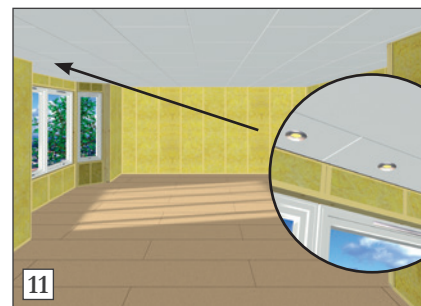

11) You may mount recessed down lights in all our ceiling panels. You can also install our panels in wet rooms, provided normal ceiling height and good ventilation is available. (For down-lights, see NBI 543.615).





WALL PANEL DESIGN



Please see www.Huntonit.fi
or Huntonit.com for more info
regarding Huntonit Design.





HUNTONIT

Huntonit AS
Pb 21, 4701 Vennesla
NORWAY

Tel: +47 38 13 71 00
Fax: +47 38 13 71 01
E-mail: byggma@byggma.no
www.byggmagroup.com
www.huntonit.com